

**CALL US TO SEE THIS PROPERTY
PAMELA & JOSE BANCHS
KELLER WILLIAMS REALTY
DIRECT 508-847-0653**

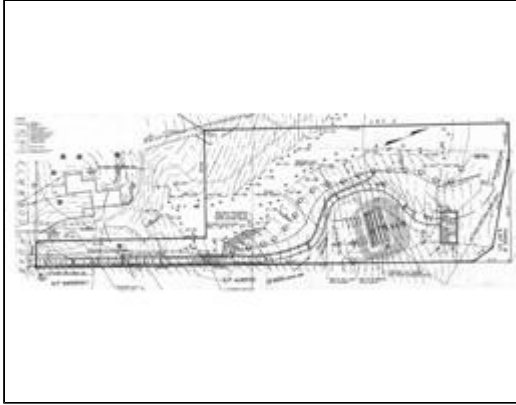

**MLS # 70918830 - Price Changed
Land - Residential**

LOT 4-C Elmwood List Price: **\$133,000**

Lunenburg, MA 01462

Worcester County

Grade School:

Middle School:

High School:

Directions: **ROUTE 2A TO ELMWOOD ROAD - CLOSE TO 191 ELMWOOD**

Remarks

Just under 4 acres, this private lot in Lunenburg consists of both woods and meadows. Approved septic plan in hand. Ideal setting to build a quiet country home with plenty of room for outdoor activities and/or horses. This property is located minutes off of Route 2A in Lunenburg, private setting set back off of Elmwood Road.

Property Information

Total Approx. Acres: **3.7 (161607.6 sq. ft.)**

Cultivation Acres:

Home Own Assn:

No. of Approved Lots:

Pasture Acres:

Assn Req:

Approx. Street Frontage:

Timber Acres:

HOA Fee : \$

Features

Beach: **No**

Cable Available:

Documents: **Septic Design**

Electric: **At Street**

Gas: **None**

Land Description: **Level**

Sewer: **Private**

Water: **Private, Public**

Waterfront: **No**

Zone Usage: **Single Family**

Other Property Info

DEQE/DEP#:

Disclosure Declaration: **No**

Disclosures:

Perc Test: **Yes**

Tax Information

Pin #:

Assessed: **\$143,700**

Tax: **\$1743** Tax Year: **2008**

Book: **6519** Page: **35**

Cert:

Zoning Code: **RES**

Map: Block: Lot:

The information in this listing was gathered from third party sources including the seller and public records. MLS Property Information Network and its subscribers disclaim any and all representations or warranties as to the accuracy of this information. Content ©2009 MLS Property Information Network, Inc.

www.pamelabanchs.com